

The heights is being constructed in nature and not legal document
The developer retains the right to discontinue the project at any time without any liability

VFXME - VFXMEDIGITAL.COM



HMR
AURUM
HEIGHTS



HMR Developers (PVT) Limited,
Aurum Heights Sales Centre
Adjacent to Plot 3 & 4
Gulberg Expressway
Off Islamabad Highway
Islamabad, Pakistan.

Sale Centre Tel: +92 348 111 6 555

Email: aurum@hmr.ae www.hmr.ae

HMR
AURUM
HEIGHTS

Hazaraohn Khawishon
Ka Ek Makam





REDEFINING REALITY IN
ISLAMABAD

Location

Aurum Heights is located in the Master Community of Gulberg Green Islamabad (GG) is located off Islamabad Highway, a project of Intelligence Bureau Employee's Cooperative Housing Society (IBECHS).

GG master plan comprise of Exclusive Farm Houses, Residential Plots, Apartment Buildings, Corporate Office Towers, Five Star Hotel, Mega Shopping Mall, Schools, Colleges and Universities, Hospital, Masjids, Parks, Lakes, Recreational Facilities and various other amenities.





HMR
AURUM
HEIGHTS

Hazaraohn Khawishon
Ka Ek Makam

Aurum Heights

AURUM HEIGHTS is a two phase project, the first phase has been launched by HMR Group.

- **Project Land Area:** 9,067 square yards
- **Master Community:** Gulberg Greens
- **Location:** On Main Gulberg Expressway at the entrance of Gulberg Green
- **Project Building:** Comprised of three towers with common basements and podium at ground and first floor. Middle Tower is beautifully designed curved shaped and two side towers are square shaped. Tower-1 (left side tower) above the podium will comprise of Offices whereas Tower-2 (middle) & Tower-3 (right side tower) above podium will comprised of residential apartment.
- **Showrooms** entrances are from front side of the building
- **Apartment** entrances are from back side of the building to provide complete privacy
- **No of Floor:** 14-Floors (2B+G+11): 2-Basements for Residents' Car Parking, Ground + First for Exclusive Showrooms, Nine Floors for Residential Apartments and Offices
- **Phase-2** of the project is of same magnitude



FAZAIA COLONY

MADINA TOWN

BENAZIR BHUTTO
INTERNATIONAL AIRPORT

GULBERG GREEN
ISLAMABAD

KORAL CHOWK

GHORJI MODEL TOWN

AURUM HEIGHTS SITE

GULBAHAR SCHEME

EXECUTIVE BLOCK

GULBERG EXPRESS WAY

Location

AURUM HEIGHTS IN GULBERG GREEN, ISLAMABAD

HMR
AURUM
HEIGHTS

REDEFINING REALITY IN
GULBERG GREEN

The location of Gulberg Green is as beautiful as Islamabad; it is just 15 minutes drive to other parts of Islamabad, and 10 minutes' drive to Benazir Bhutto International Airport and 5 minutes' drive to G.T Road.



All the desires of your heart have one address

Hmr Aurum Heights



HMR
AURUM
HEIGHTS

Hazaraohn Khawishon
Ka Ek Makam

Apartments in Aurum Heights are designed to suit all budgets, & come in various sizes from one bedroom, two bedroom, three bedroom & spacious four bedroom duplex penthouses.

One Bedroom Apartment



HMR
AURUM
HEIGHTS

Hazaraohn Khawishon
Ka Ek Makam



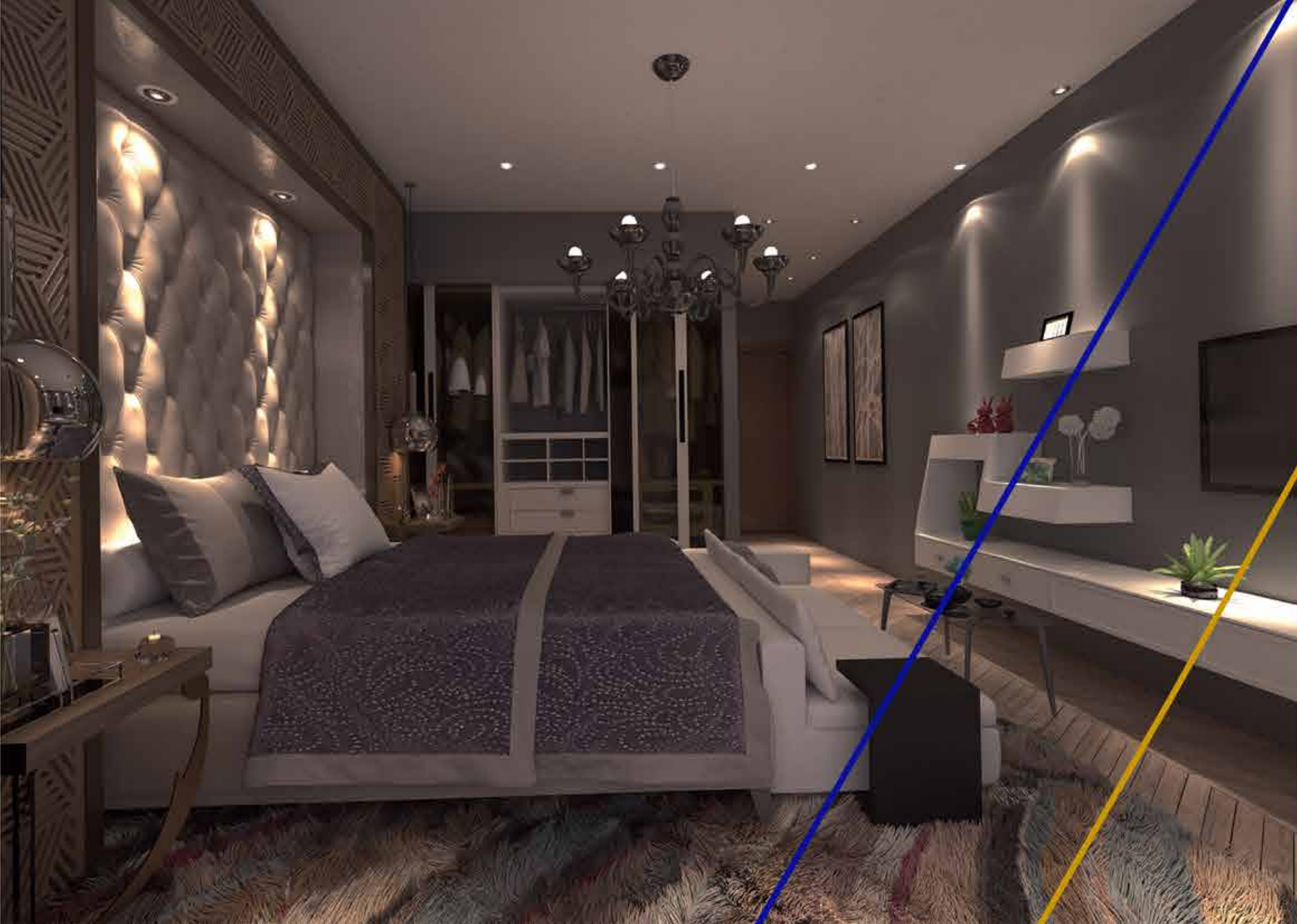

Apartments in Aurum Heights are designed to suit all budgets, & come in various sizes from one bedroom, two bedroom, three bedroom & spacious four bedroom duplex penthouses.

Two Bedroom Apartment



HMR
AURUM
HEIGHTS

Hazaraohn Khawishon
Ka Ek Makam

Apartments in Aurum Heights are designed to suit all budgets, & come in various sizes from one bedroom, two bedroom, three bedroom & spacious four bedroom duplex penthouses.

Three Bedroom Apartment



HMR
AURUM
HEIGHTS

Hazaraohn Khawishon
Ka Ek Makam





Apartments in Aurum Heights are designed to suit all budgets, & come in various sizes from one bedroom, two bedroom, three bedroom & spacious four bedroom duplex penthouses.

Four Four Bedroom Duplex Penthouse



HMR
AURUM
HEIGHTS

Hazaraohn Khawishon
Ka Ek Makam

Aurum Heights will have the entire ground floor for retail outlets, with finest of local and international brands occupying prominent frontage. On the higher levels a complete tower in the project will have office space of the highest standards and amenities.

Defining Retail Showrooms and Offices



HMR
AURUM
HEIGHTS

Hazaraohn Khawishon
Ka Ek Makam





Project Features & Facilities

- All Apartment Designed To Provide Natural Light To All Rooms
- Spacious Bedrooms With Attached Bathrooms
- Wide Balconies For Every Apartment
- Selected Smart Home System
- High End Tile Flooring
- High End Tile, Fixtures And Fitting In Bathrooms
- Imported Light Fixtures
- Double Glazed Windows
- Built-in Wardrobes
- Modern Kitchen, Corian Counter Top, Electric Hob & Hood
- Centrally Air Conditioned
- Basement Car Parking For Residents
- Fire Stair Case As Per International Standards
- Fire Fighting System As Per International Standards
- Mechanical Ventilation For Apartment
- Mechanical Ventilation For Basement





Project Features & Facilities

- 24 Hours Power Backup Supply System
- CCTV System
- Fire Alarm System
- Access Control System
- Garbage Chute System
- Central Security System
- High Speed High End Imported Lifts
- Latest Gpon Fiber Optics System For TV, Telephone And Data
- Dedicated Apartment Reception And Waiting Area
- Facilities Management System
- Male And Female Swimming Pool, Gymnasium & Lockers
- Anchor Showrooms
- Prayer Hall, Ablution, Male & Female Toilets, Mother Care
- Drivers Waiting Room & Toilets
- Long & Short Term Parking Facility For Shoppers



HMR
AURUM
HEIGHTS
ONE BEDROOM APARTMENT



3D LAYOUT



UNIT LAYOUT

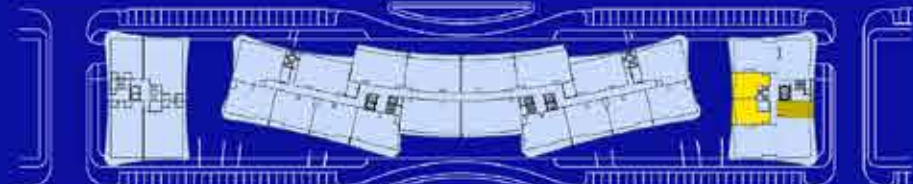

KEY PLAN

HMR
AURUM
HEIGHTS
TWO BEDROOM APARTMENT



3D LAYOUT



UNIT LAYOUT

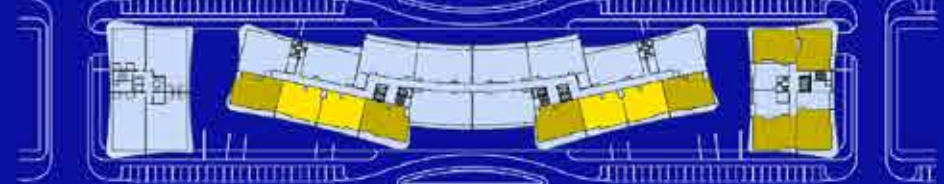

KEY PLAN

HMR
AURUM
HEIGHTS
FOUR BED DUPLEX PENTHOUSE
LOWER LEVEL



TERRACE
487.00 SFT.



UNIT LAYOUT



3D LAYOUT

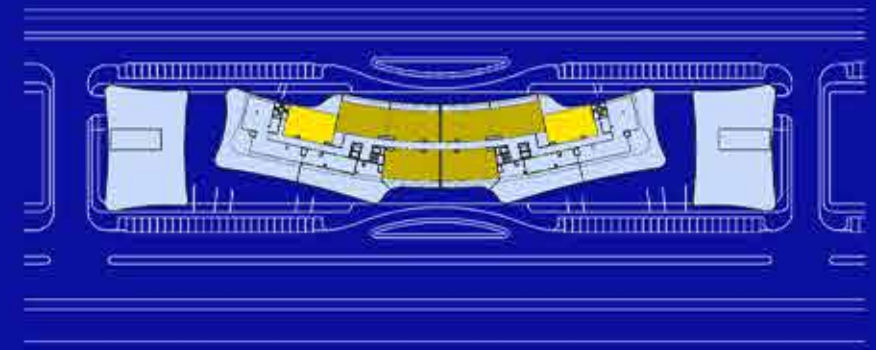

KEY PLAN

HMR
AURUM
HEIGHTS
FOUR BED DUPLEX PENTHOUSE
UPPER LEVEL



TERRACE
454.00 SFT.



UNIT LAYOUT



3D LAYOUT

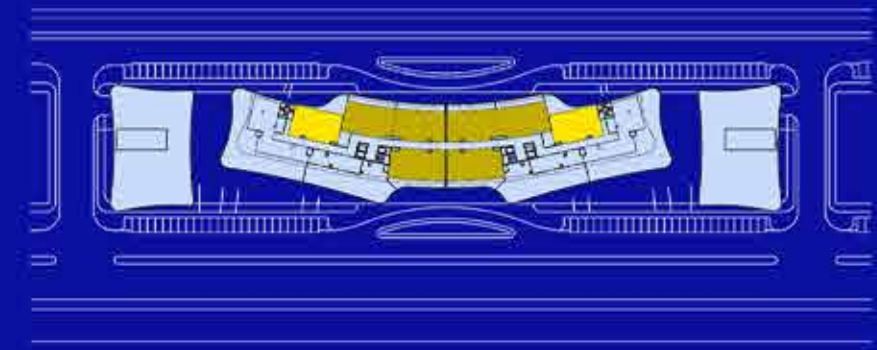

KEY PLAN

NORTH AVENUE (80'-0" WIDE ROAD)

PARKING PLAZA

SERVICE LANE

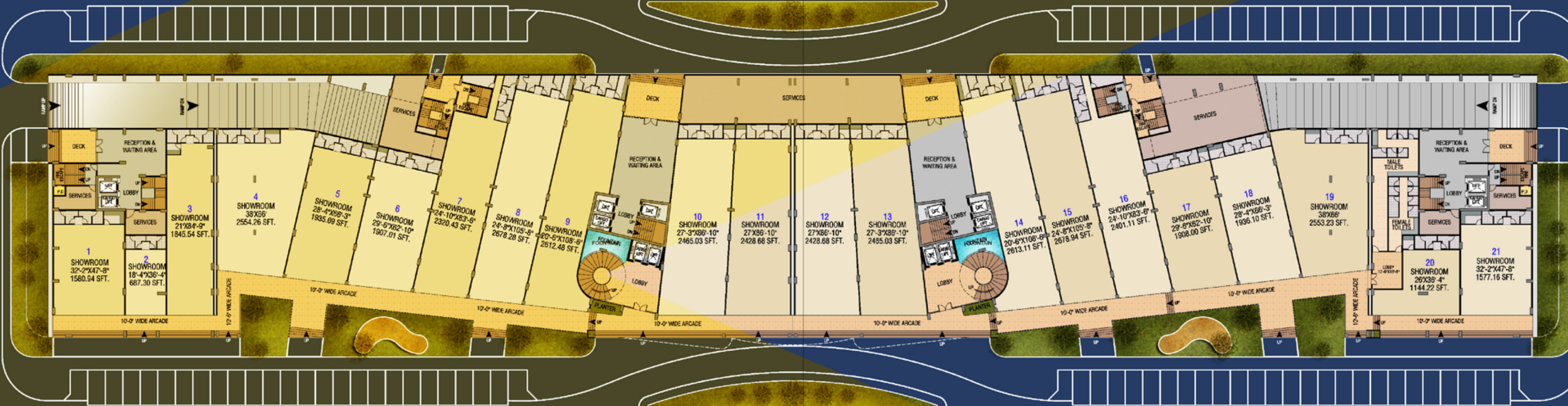

SERVICE LANE

GULBERG EXPRESSWAY (220'-0" WIDE ROAD)

SERVICE LANE

SERVICE LANE

PARKING



NORTH AVENUE (80'-0" WIDE ROAD)

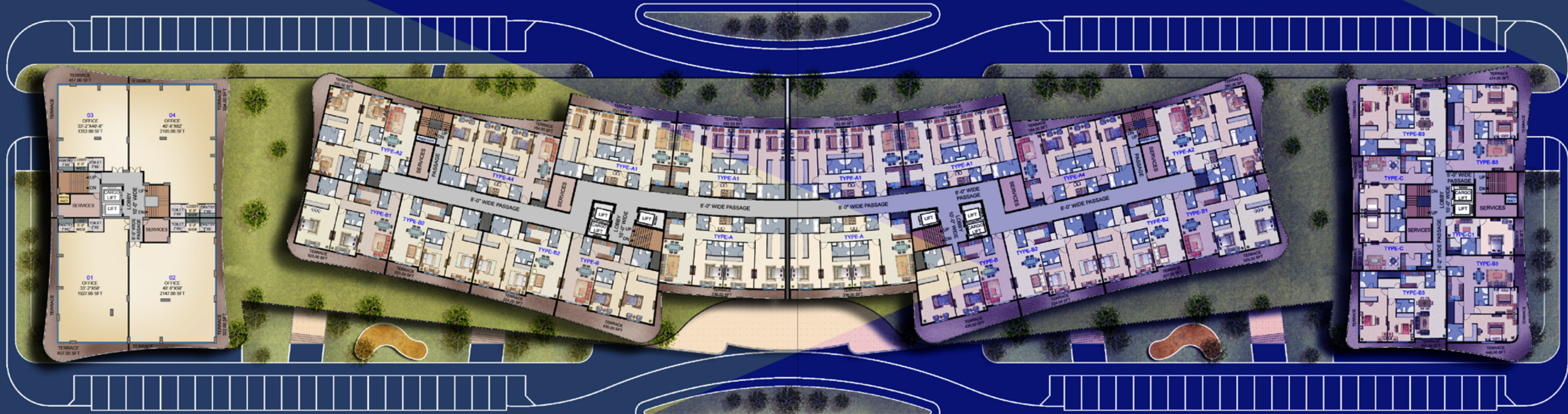

GULBERG EXPRESSWAY (220'-0" WIDE ROAD)

NORTH AVENUE (80'-0" WIDE ROAD)

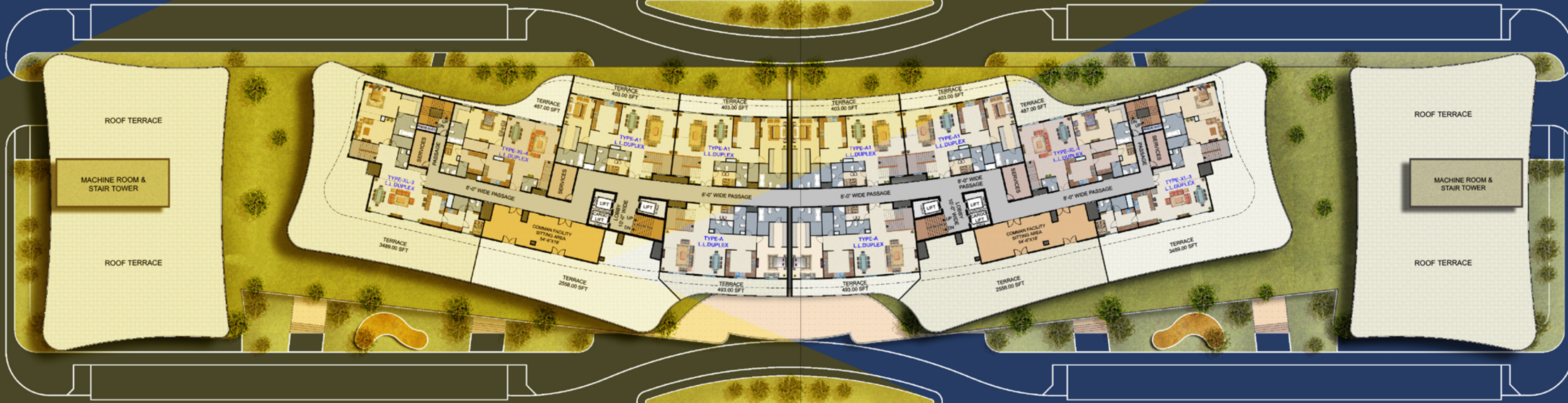

GULBERG EXPRESSWAY (220'-0" WIDE ROAD)





HMR GROUP

REDEFINING REALITY

HMR Group is a business conglomerate; a leading real estate developer in Pakistan and the UAE. HMR Group is deeply rooted into 100 years of family business history. Haji Muhammad Rafiq Pardesi, Chairman of the Group, with over 35 years of business acumen and experience leads a core team of professionals in business ventures that span from Real Estate, Gold and Bullion Trading to Textiles, across three continents in Asia, Middle East and Africa. The Group has won prestigious awards in all three business segments of its operations, Globally.

Today, with its solid performance in building and delivering real estate projects in Pakistan, as well as Dubai and Ajman in the UAE, HMR'S Group is poised to write the next chapter by Redefining Reality in Pakistan by launching its first project in Islamabad.

REDEFINING REALITY

HMR is Redefining Reality

HMR GROUP'S REAL ESTATE PROJECTS ACCROSS THE GLOBE

Lahore Pakistan: HMR Group is developing Gold Crest Mall & Residency; on a land measuring 13,775 square yards located at Phase IV of DHA Lahore. The project occupies perhaps the most lucrative landmark. The dual facet project will have one of the most premier shopping malls of 18 levels, ground plus 14 floors and 4 basements. The Residency tower of 10 floors will have 254 luxurious apartments that redefine your living experience.

Karachi Pakistan: HMR Group is developing an iconic waterfront real estate project comprising of 21 high and medium rise residential and commercial towers; on land measuring 36.2 acres. This project offers unparalleled views of the ocean as it is located on the shores of the Arabian Sea in Phase VIII DHA Karachi. The project will be a gated community with all the amenities and facilities including a hotel/service apartment, club house, mosque, and retail areas. This waterfront development, a prestigious project will change the skyline of Karachi and redefine for the city's elite how they live, work, play and shop.

Ajman UAE: HMR Group is developing Goldcrest Dreams comprising of 10 residential towers located on Emirate Road Ajman. The project is designed to provide quality housing to middle income families redefining their lifestyle. The handover and delivery of apartments began in 2017 and will continue till all the towers are completed.



HMR GROUP